

THE SUGAR HOUSE

1820 square feet

It's spring here in Vermont and time to tap the Maple trees and fire up the evaporator. Timber Creek's Sugar House brings this scene to mind with a lighted long cupola, compact interior design, and an abundance of exterior living found on the 3 porches and decks. This home features a wonderfully situated kitchen / dining area with easy access to the deck and covered porch. All bedrooms have ample room and the den / study is a great bonus in a home of this size. The cupola casts plenty of natural light down to the balcony and family room for a nice ambiance and visual drama. The Sugar House has it all in a great floor plan under 2000 square feet.

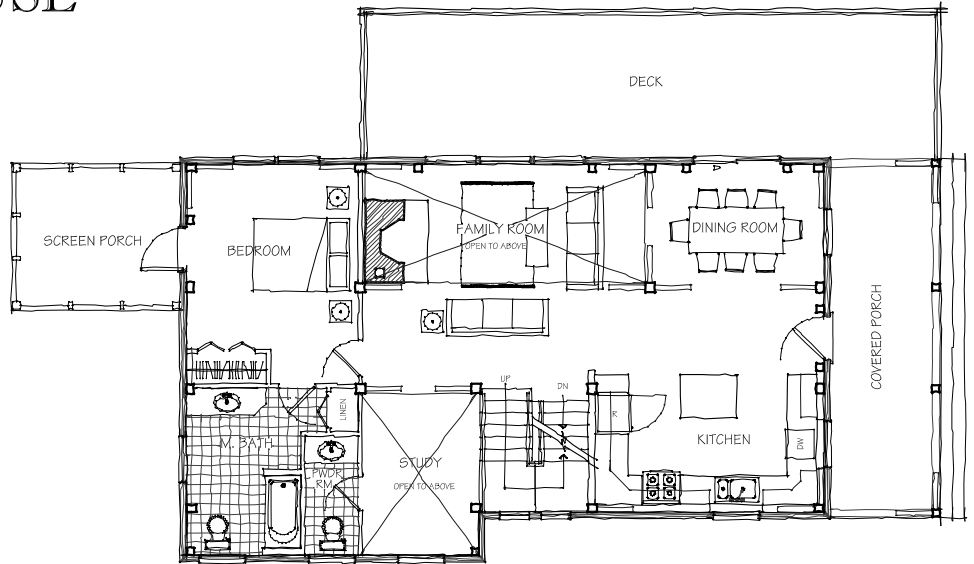

FIRST FLOOR PLAN
1st FLOOR PLAN = 1056 s.f.

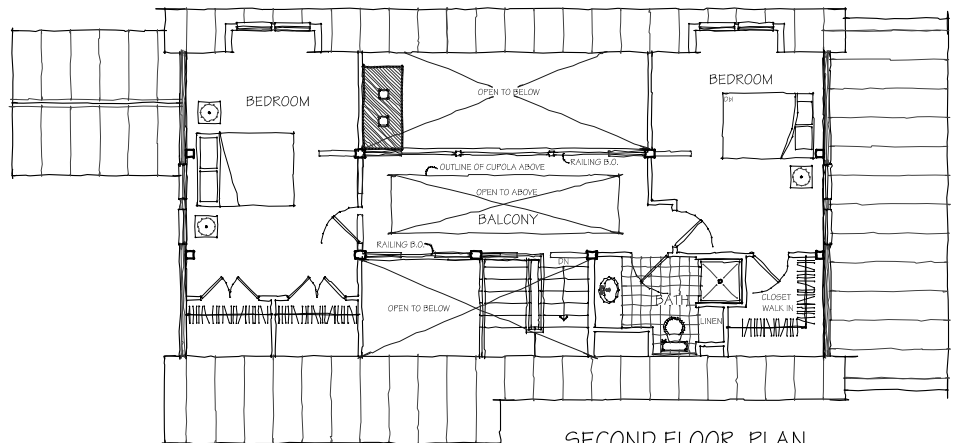

SECOND FLOOR PLAN
2nd FLOOR PLAN = 768 s.f.



TIMBER CREEK
POST & BEAM COMPANY

P.O. Box 90 ~ N. Clarendon, VT 05759
802.775.6591 ~ info@timbercreekinc.com
timbercreekinc.com